

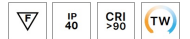

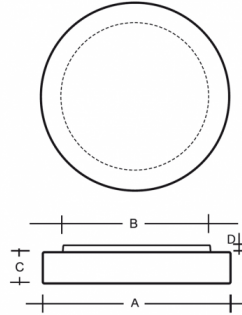



ZERO S29.12.Z330.Y

Typ: Decken- und Wandleuchte

Lampenschirm: weißes, mundgeblasenes, dreischichtiges Opalglas seidenmatt

Leuchte: weiß lackiertes Stahlblech



|  |  | A | B | C | D |  |  |  |
|---|---|-----|-----|----|----|---|---|---|
| E27 | 2×60(46)W | 330 | 290 | 70 | 20 | O* | – | 2500 |

Spannung: 230V

IK Code: IK01

Fassung: E27

Leuchtmittel: 2×60(46)W

A: 330 mm

B: 290 mm

C: 70 mm

D: 20 mm

Bewegungsmelder: Verfügbar auf Anfrage

Track-System: Nicht Verfügbar

Gewicht: 2500 g

Luminaire S29.112.Z330 ZERO / LDC (Polar)

Luminaire: Lucis S29.112.Z330 ZERO
Lamps: 2 x Osram A CL 60W E27

