

POLARIS ZL PE ZL1.11.400.XY PE

Type: suspension lamp

Lampshade: polyethylene opal PE

Metal parts: painted steel plate RAL 9003 (.31), RAL chrom (.77) or chrome (.80)

Pendant: steel wire suspension with a transparent cable

Colour: RAL chrom (77) 6 (77)

The luminaire driver is placed right inside the luminaire (LED version).

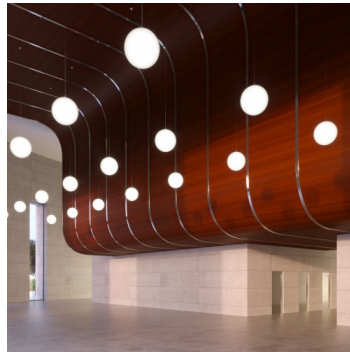

						
E27	1×150(116)W	400	2000	-	R*	3200

Voltage: 230V

IK code: IK10

Socket: E27

Lamps: 1×150(116)W

A: 400 mm

C: 2000 mm

Motion sensor: Not available

Track system: Available on inquiry

Weight: 3200 g

Lucis ZL1.11.400.X PE POLARIS ZL PE / LDC (Polar)

Luminaire: Lucis ZL1.11.400.X PE POLARIS ZL PE
Lamps: 1 x OSRAM 150W

