

CHARON IP44 PS37.L2.T14.Y

Type: ceiling and wall lamp

Lampshade: white, hand-blown, three-layered glass, satin opal matt

Light body: white painted steel plate

Could be combined with metal ring in white, chrome, brass or stainless steel.

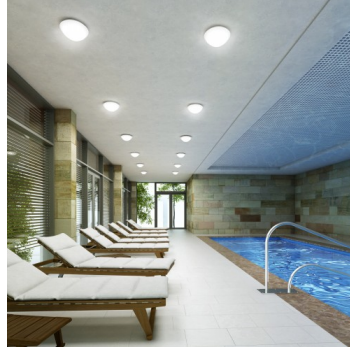
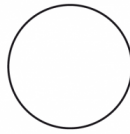
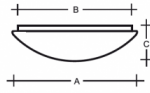

W	K	Module luminous flux lm	Luminaire luminous flux lm	A	B	C	DALI 2	Motion sensor	Emergency	Bluetooth	Track system	Weight
21,3	4000	3476	2359	415	370	125 Project 1	M	O*	P*	O*	-	4100 g

Operator
Telephone
Fax
e-Mail

DIALUX
11.03.2024

Voltage: 230V

IK code: IK01

Ballast: Driver

CRI: >90

LED life: L80/F10 50000 hours

Watt: 21,3 W

Color temperature: 4000 K

Module luminous flux: 3476 lm

Luminaire luminous flux: 2359 lm

A: 415 mm

B: 370 mm

C: 125 mm

Dali 2: Available

Motion sensor: Available on inquiry

Emergency module: Available on inquiry

Bluetooth control: Available on inquiry

Track system: Not available

Sádrokarton: Not available

Weight: 4100 g

Lucis PS37.L2.T14 CHARON LED / LDC (Polar)

Luminaire: Lucis PS37.L2.T14 CHARON LED
Lamps: 1 x LED G6

