

TENDO PMMA S33.K1.TEZ3.Y

Type: ceiling and wall lamp

Lampshade: acrylic glass PMMA

Light body: white painted steel plate

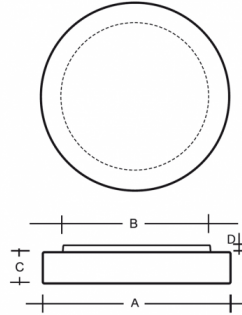

W	K	Module luminous flux lm	Luminaire luminous flux lm	A	B	C	D	DALI 2	IK10	IK11	Bluetooth	Emergency	Track	Weight
36	3000	4448	3335	370	330	70	20	M	O*	P*	Q*	-	-	1900

Voltage: 230V

Ballast: Driver

IK code: IK10

CRI: >90

LED life: L80/F10 50000 hours

Watt: 36 W

Color temperature: 3000 K

Module luminous flux: 4448 lm

Luminaire luminous flux: 3335 lm

A: 370 mm

B: 330 mm

C: 70 mm

D: 20 mm

Dali 2: Available

Motion sensor: Available on inquiry

Emergency module: Available on inquiry

Bluetooth control: Available on inquiry

Track system: Not available

Sádrokarton: Not available

Weight: 1900 g

Lucis S33.K1.TEZ3 TENDO LED / LDC (Polar)

Luminaire: Lucis S33.K1.TEZ3 TENDO LED
Lamps: 1 x LED G5

