

TENDO PMMA S26.K2.TEZ2.Y

**Type:** ceiling and wall lamp

**Lampshade:** acrylic glass PMMA

**Light body:** white painted steel plate

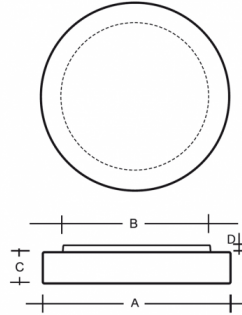

W	K	Module luminous flux lm	Luminaire luminous flux lm	A	B	C	D	DALI 2	IK10	IK11	Bluetooth	Emergency	Weight
18,1	4000	2491	1790	300	260	70	20	M	-	-	Q*	-	1200

**Voltage:** 230V

**Ballast:** Driver

**IK code:** IK10

**CRI:** >90

**LED life:** L80/F10 50000 hours

**Watt:** 18,1 W

**Color temperature:** 4000 K

**Module luminous flux:** 2491 lm

**Luminaire luminous flux:** 1790 lm

**A:** 300 mm

**B:** 260 mm

**C:** 70 mm

**D:** 20 mm

**Dali 2:** Available

**Motion sensor:** Not available

**Emergency module:** Not available

**Bluetooth control:** Available on inquiry

**Track system:** Not available

**Sádrokarton:** Not available

**Weight:** 1200 g

Lucis S26.K2.TEZ2 TENDO LED / LDC (Polar)

Luminaire: Lucis S26.K2.TEZ2 TENDO LED  
Lamps: 1 x LED G5

