

AULA AU3.L4.600.XY

**Type:** luminaire mural

**Abat-jour:** verre acrylique

**Luminaire:** tôle dacier revêtue RAL 9016 (.41), RAL 7012 (.47), RAL Argento dorato (.70), RAL Copper (.72), RAL Bronze (.73), RAL Brass (.74)

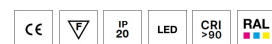
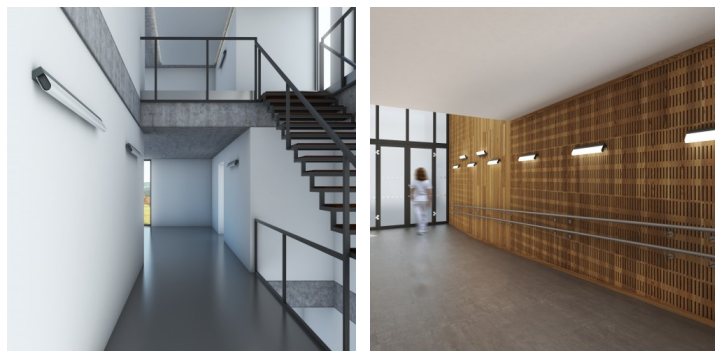
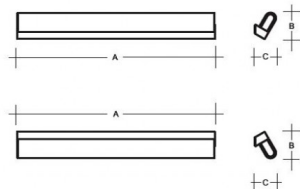

| W   | K    | Module<br>luminous<br>flux lm | Luminaire<br>luminous<br>flux lm | A   | B   | C  | DALI<br>2 | IK<br>06 | Q* | Bluetooth | Track<br>system | Weight |
|-----|------|-------------------------------|----------------------------------|-----|-----|----|-----------|----------|----|-----------|-----------------|--------|
| 9,1 | 4000 | 1278                          | 1205                             | 640 | 120 | 95 | M         | -        | -  | Q*        | -               | 1800   |

Lucis AU3.L4.600.X AULA LED / LDC (Polar)

**Tension:** 230V

**IK code:** IK06

**Ballaste:** Driver

**CRI:** >90

**La vie de LED:** L80/F10 50000 heures

**Watt:** 9,1 W

**Température Couleur:** 4000 K

**Module luminous flux:** 1278 lm

**Luminaire luminous flux:** 1205 lm

**A:** 640 mm

**B:** 120 mm

**C:** 95 mm

**Dali 2:** Disponible

**Capteur de mouvement:** Non disponible

**Module d'urgence:** Non disponible

**Contrôle Bluetooth:** Disponible sur demande

**Track system:** Non disponible

**Sádrokarton:** Non disponible

**Poids:** 1800 g

Luminaire: Lucis AU3.L4.600.X AULA LED  
Lamps: 1 x LED G6

