

AULA AU3.L3.1500.XY

Type: luminaire mural

Abat-jour: verre acrylique

Luminaire: tôle d'acier revêtue RAL 9016 (.41), RAL 7012 (.47), RAL Argento dorato (.70), RAL Copper (.72), RAL Bronze (.73), RAL Brass (.74)

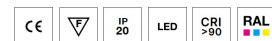
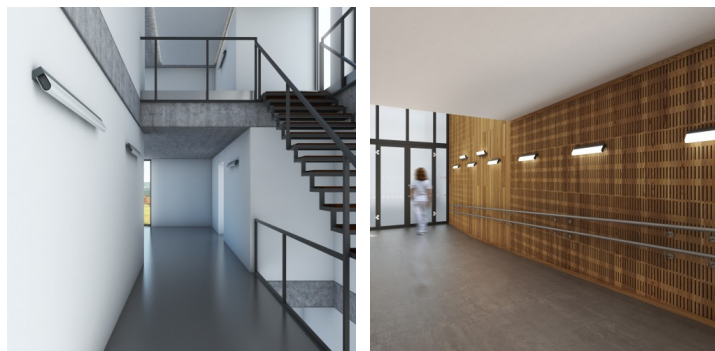
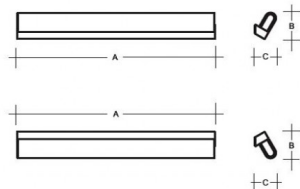

W	K	Module luminous flux lm	Luminaire luminous flux lm	A	B	C	DALI 2	☺	☒	⚡	📄	🏷️
26,5	3000	3670	3448	1500	120	95	M	-	-	Q*	-	4000

Lucis AU3.L3.1500.X AULA LED / LDC (Polar)

Tension: 230V

IK code: IK06

Ballaste: Driver

CRI: >90

La vie de LED: L80/F10 50000 heures

Watt: 26,5 W

Température Couleur: 3000 K

Module luminous flux: 3670 lm

Luminaire luminous flux: 3448 lm

A: 1500 mm

B: 120 mm

C: 95 mm

Dali 2: Disponible

Capteur de mouvement: Non disponible

Module d'urgence: Non disponible

Contrôle Bluetooth: Disponible sur demande

Track system: Non disponible

Sádrokarton: Non disponible

Poids: 4000 g

Luminaire: Lucis AU3.L3.1500.X AULA LED
Lamps: 1 x LED G6

