

AULA AU3.L1.1200.XY

Type: wall lamp

Lampshade: acrylic glass

Light body: painted steel plate RAL 9016 (.41), RAL 7012 (.47), RAL Argento dorato (.70), RAL Copper (.72), RAL Bronze (.73), RAL Brass (.74)

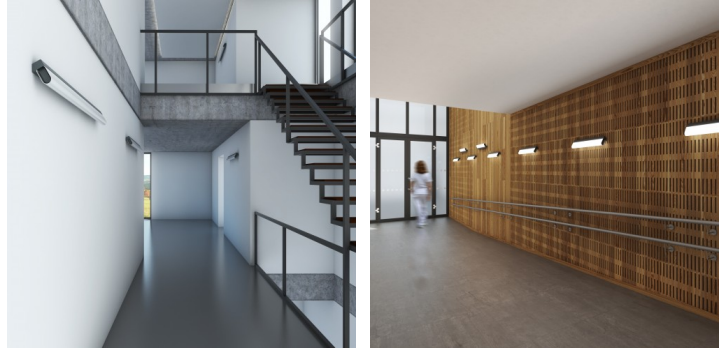
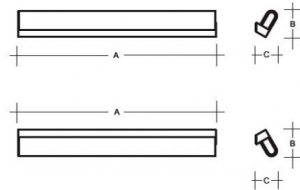

W	K	Module luminous flux lm	Luminaire luminous flux lm	A	B	C	DALI 2	Motion sensor	Emergency module	Bluetooth	Track system	Weight
42	3000	5704	5359	1200	120	95	M	-	-	Q*	-	3300

Lucis AU3.L1.1200.X AULA LED / LDC (Polar)

Voltage: 230V

IK code: IK06

Ballast: Driver

CRI: >90

LED life: L80/F10 50000 hours

Watt: 42 W

Color temperature: 3000 K

Module luminous flux: 5704 lm

Luminaire luminous flux: 5359 lm

A: 1200 mm

B: 120 mm

C: 95 mm

Dali 2: Available

Motion sensor: Not available

Emergency module: Not available

Bluetooth control: Available on inquiry

Track system: Not available

Sádrokarton: Not available

Weight: 3300 g

Luminaire: Lucis AU3.L1.1200.X AULA LED
Lamps: 1 x LED G6

